



MINI-78 Channel

Service . Range . Knowledge



Welcome To Polycon

Polycon is identified as one of the leading manufacturers, distributors, and suppliers of channel drainage in the UK. We focus towards creating a diverse range of water solutions, in a variety of different materials, including composite, polymer concrete, SMC, and steel.

Polycon's unique look at the market and expert knowledge of the industry ensures that we can supply a wide range of high-quality products suitable for any application. This includes building drainage, landscaping, sports facilities, distribution centres, highways, and airports.

Our design team provides innovative and efficient hydraulic solutions to ensure we can offer the best product/ solution for your drainage needs. We have a vast and experienced overview of our working industry and have been manufacturing, distributing, and selling channel drainage for over 8 years. We thrive on acting upon your feedback to improve and develop our products to fit flawlessly with the constantly changing market and demand from our customers.

At Polycon we focus our attention on professionals who sit within the construction industry, targeting our products to specifiers, architects, engineers, and contractors. Therefore, we understand the importance of expanding our product portfolio to create the most efficient surface water drainage systems.

We are a dynamic and evolving company with a focus on quality, innovation, and service. As a result, you can rely on us to handle your project needs in every way to the best of our ability.

Contents

MINI-78	3
MINI-78 Overview	5
Accessories	7
Gratings	8
Installation Guide	9

MINI-78 Channel

The Mini-78 channel drainage system offers a multitude of benefits in its compact design. Firstly, it's incredibly lightweight, making it effortless to handle and install. This ultimately reduces the time and effort needed for installation. This system is also constructed from materials that are both chemical resistant and resistant and rust-proof, ensuring longevity and reliability, even in challenging environments.

The Mini-78 drainage system is remarkably easy to install without the need for trenches. This not only saves time but also minimises disruption to your property. Its watertight and secure protection mechanisms ensure your property remains safeguarded against leaks and water-related damage.

The non-directional design of this system eliminates the complexity of right or left-handed fittings, streamlining the installation process and reducing the risk of error. These combined benefits make the Mini-78 channel drainage system a smart and efficient choice for a wider range of construction and renovation projects.

Another standout feature is its discreet and minimalistic design, ensuring it seamlessly blends into any environment without disrupting the aesthetics. Polycon offers a diverse selection of coloured gratings, allowing you to customize the channel's appearance to match your design preferences or surroundings. Additionally, a full range of accessories, including end caps, connectors, and outlets, simplifying installation and customisation.

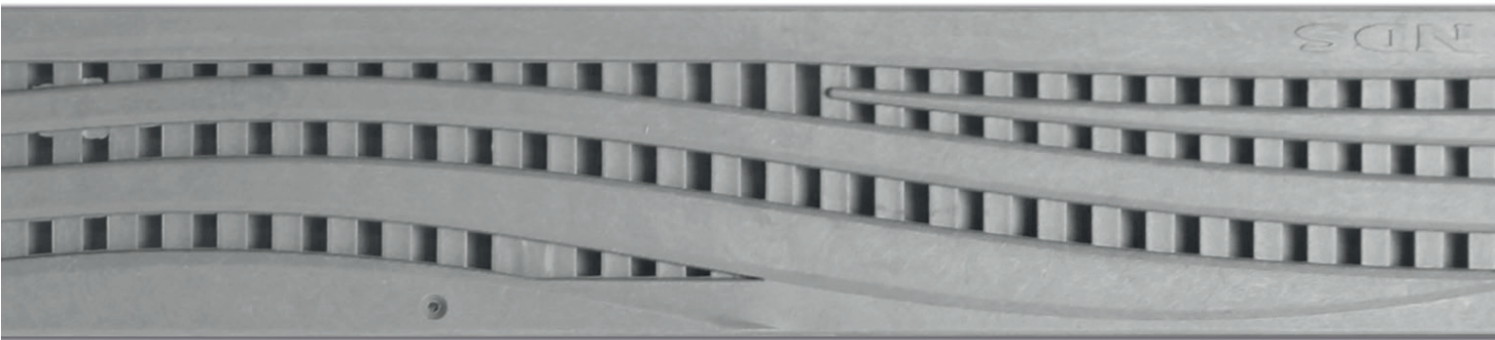

Load Class



Applications

- Landscaping areas
- Pools and leisure
- Gardens
- Playgrounds

MINI-78

VIRTUAL LANDSCAPE

Not sure what you are looking for?

Check out our MINI-78 systems against multiple paving backgrounds on our virtual landscape feature. You can mix and match gratings against multiple backgrounds to achieve the ultimate desired look. Each visual can be downloaded as a PDF and sent to customers along with a technical overview of your chosen system.

Try today at www.polycon.co.uk.



MINI-78 Channel - Overview

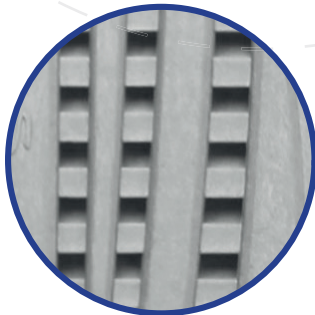

Grating Options

Polycon's Mini-78 channel stands out as an exceptional drainage solution, offering both versatility and aesthetic appeal. The slotted grating option, provides an impressive array of five distinct colours, allowing customers to harmonize the drainage system with their specific design preferences or the surrounding environment effortlessly. Furthermore, the wave grating offers three unique colour choices, adding even more versatility to their product range. With this broad spectrum of colour options available, the Mini-78 channel not only excels in functionality but also enhances the visual appeal of any residential space.



SAFEHEEL

Colour Options

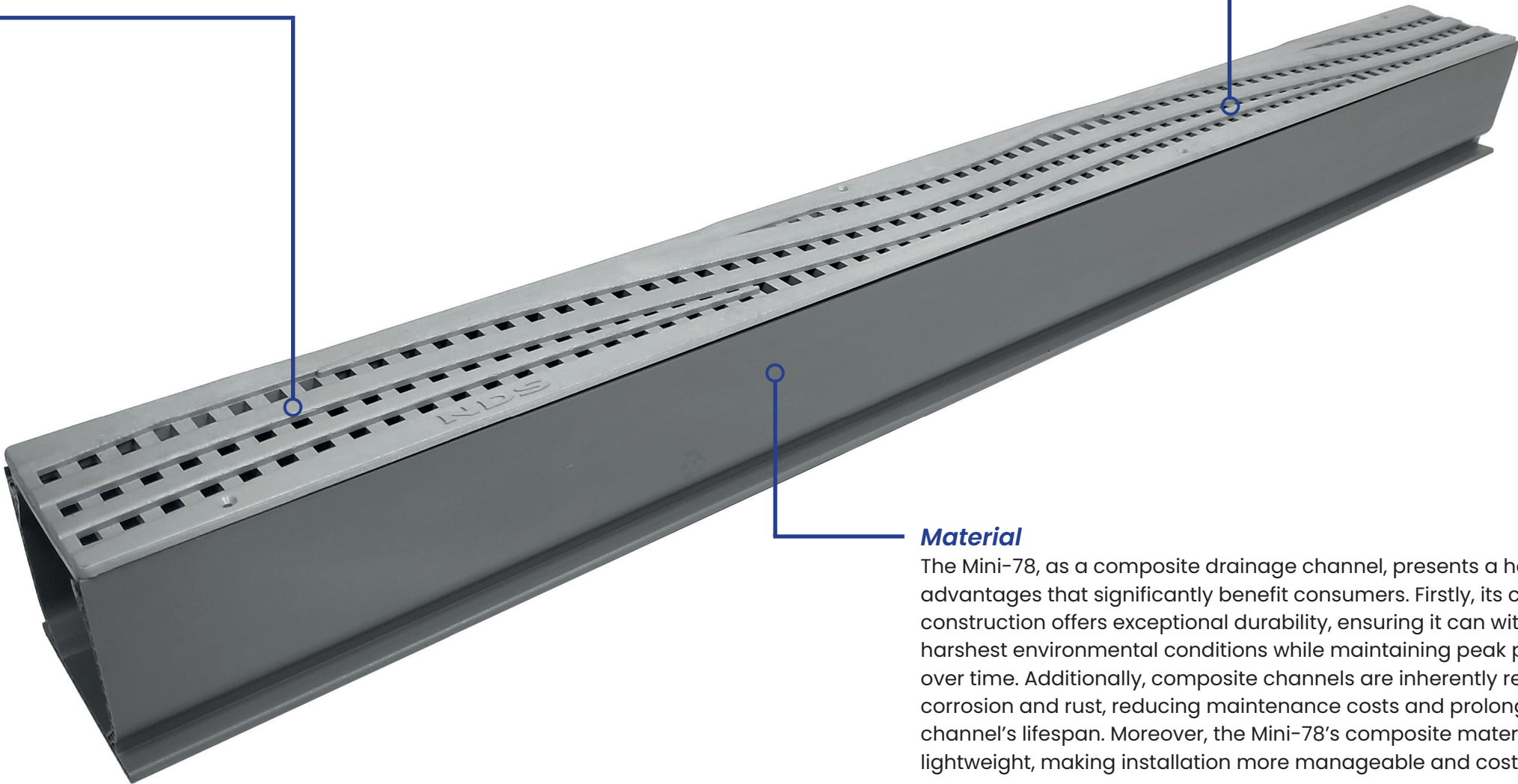

Material

The Mini-78, as a composite drainage channel, presents a host of advantages that significantly benefit consumers. Firstly, its composite construction offers exceptional durability, ensuring it can withstand the harshest environmental conditions while maintaining peak performance over time. Additionally, composite channels are inherently resistant to corrosion and rust, reducing maintenance costs and prolonging the channel's lifespan. Moreover, the Mini-78's composite materials are lightweight, making installation more manageable and cost-effective.

Load Classes



1.5t

A15

Depth Options

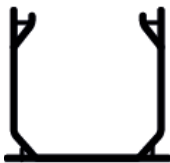

80mm

MINI-78 Channel

The Mini-78 drainage channel supplied by Polycon offers a discreet design, multiple different options for customisation, a comprehensive range of accessories, durability, and ease of installation, making it an excellent choice for residential settings.

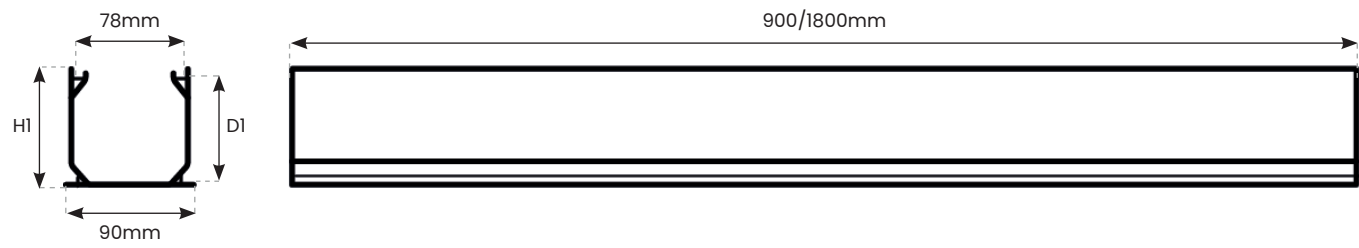

Accessories

The corner unit for the Mini-78 allows for seamless turns and angles in your drainage system. It provides a tidy and functional solution for redirecting water flow around corners.

End caps are used at the end of the channel run to stop the flow of water.

The channel Connector simplifies the process of extending or joining multiple Mini-78 drainage channels together. It allows for a secure and watertight connection between two channel sections.

The outlet connector is a crucial accessory for the Mini-78 drainage channel, providing a connection point to direct collected water to the desired outlet, such as a drain or sewer system.



Corner Unit

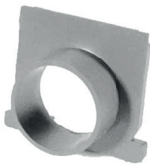

Outlet



End Cap



Connector

Accessories- Specifications

Reference	Description	Length	Height (H)	Overall Width	Weight (KG)	Outlet
CU.MINI.78	Mini-78 Corner Unit	100mm	80mm	78mm	0.5kg	-
O.MINI.78	Mini-78 Outlet	15mm	80mm	78mm	0.1kg	110mm
C.MINI.78	Mini-78 Connector	30mm	80mm	78mm	0.3kg	-
EC.MINI.78	Mini-78 End Cap	22mm	80mm	78mm	0.4kg	-

Grating Options- 78mm



Slotted Black (A15)



Slotted Tan (A15)



Slotted White (A15)



Slotted Green (A15)



Slotted Orange (A15)



Wave Black (A15)



Wave Tan (A15)



Wave Grey (A15)

Grating - Specifications

Reference	Description	Length	Internal Width	Overall Width	Overall Depth (H1)	Internal Depth (D1)	Load Class	Safe Heel
MINI.78.SGB	Mini-78 Channel + Slotted Grating Black	900/1800mm	78mm	90mm	80mm	70mm	A	Yes
MINI.78.SGT	Mini-78 Channel + Slotted Grating Tan	900/1800mm	78mm	90mm	80mm	70mm	A	Yes
MINI.78.SGW	Mini-78 Channel + Slotted Grating White	900/1800mm	78mm	90mm	80mm	70mm	A	Yes
MINI.78.SGG	Mini-78 Channel + Slotted Grating Green	900/1800mm	78mm	90mm	80mm	70mm	A	Yes
MINI.78.SGO	Mini-78 Channel + Slotted Grating Orange	900/1800mm	78mm	90mm	80mm	70mm	A	Yes
MINI.78.WGB	Mini-78 Channel + Wave Grating Black	900/1800mm	78mm	90mm	80mm	70mm	A	Yes
MINI.78.WGT	Mini-78 Channel + Wave Grating Tan	900/1800mm	78mm	90mm	80mm	70mm	A	Yes
MINI.78.WGG	Mini-78 Channel + Wave Grating Grey	900/1800mm	78mm	90mm	80mm	70mm	A	Yes

Installation Guide

Ground conditions must be suitable and all dimensions shown are the minimum requirement. Engineering advice should be taken where necessary and any questions should be directed to Polycon's technical team by emailing us at sales@polycon.co.uk or by calling us on **0151 424 9747**.



Block Paving

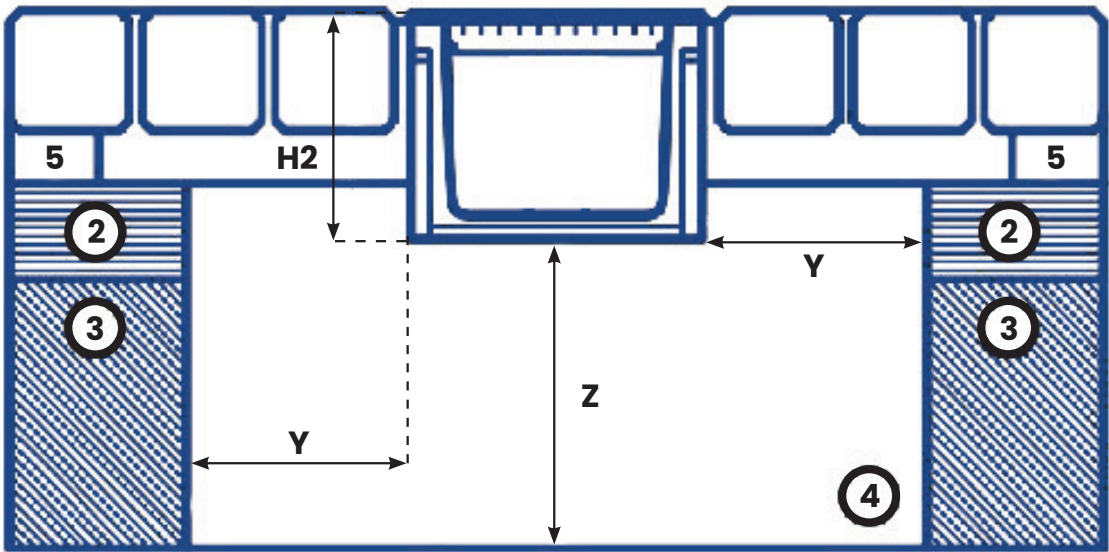

Tarmac

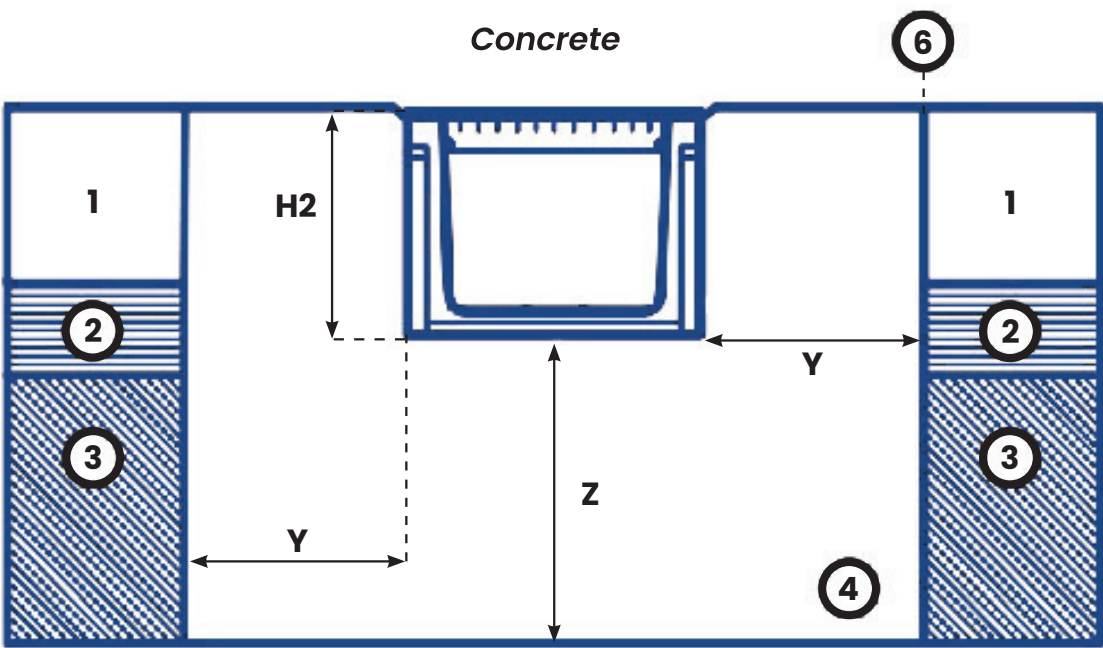
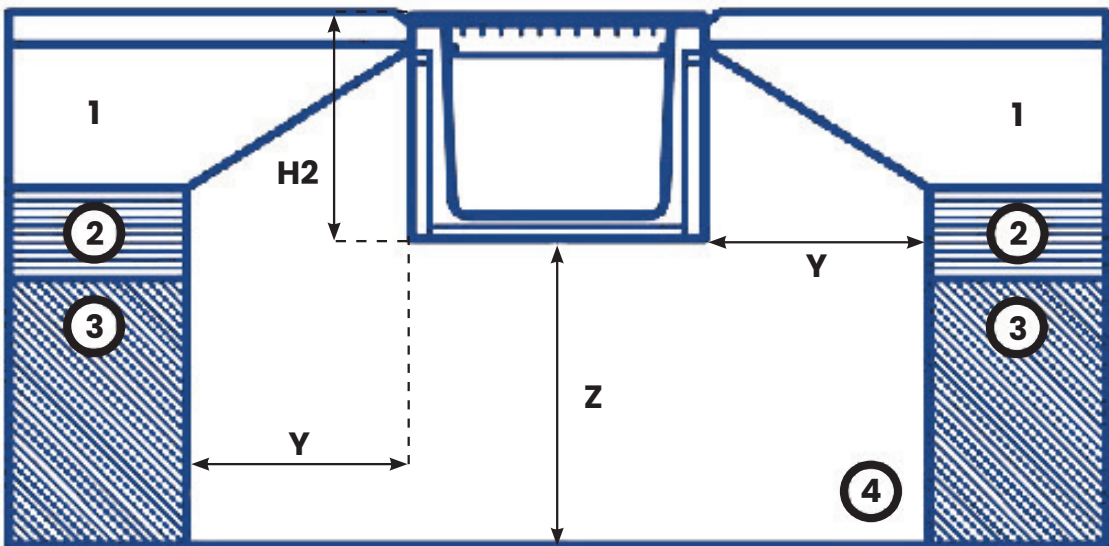

Load Class	A15
H2 - Channel Height	Channel Height
Y - Minimum Surround	100mm
Z - Minimum Surround	100mm
T1 - Minimum Depth	40mm
T2 - Maximum Depth	95mm

** Minimum Concrete Haunch 25 N/mm².
Detail A allow for overbuild of 3mm to 5mm above the grating surfaces.



Polycon Surface Water Drainage

**Widnes Business Park
Foundry Lane
Widnes
Cheshire
WA8 8UB**

**www.polycon.co.uk
0151 422 9747
sales@polycon.co.uk**

Service . Range . Knowledge